

# Zigbee wireless gateway user manual



## Product specifications

Product name	Zigbee wireless gateway
Product number	DMD2CD
Power input	DC 5V 1A
Operating temperature	-20°C ~ 45°C
Working humidity	10%-90%RH ( No condensation )
Connection method	Wi-Fi、 Zigbee

## Packing list

- 1.Smart gateway\*1
- 2.USB power cord\*1
- 3.USB charging head\*1
4. Product manual \*1

## Product description

Status  
Indicator

Distribution  
network indicator

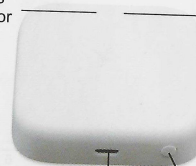

Power socket Reset button

## Preparation for use

1. Connect your phone to WIFI →  Smart phone Wi-Fi wireless router Smart host WAN

Ensure that the product is within the effective coverage of the WiFi network to ensure an effective connection between the product and the smart host (gateway)ZigBee network

\*The gateway is in the network distribution mode (the indicator lights are on at the same time)

2. Download and open the APP  
Search for "Tuya Smart" in the application store or scan the QR code on the outer packaging/instructions to download and install the APP.



## Network access settings

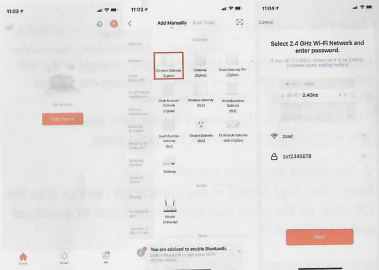

1

2

3

1. Open "Tuya Smart APP" and click Add Device
2. Click "Gateway Central Control" on the left and select "Wireless Gateway (Zigbee)"
3. After entering the WIFI and password, click Next
4. Long press the "reset button" for 5 seconds to confirm whether the indicator light is flashing, then check the "confirm that the indicator light flashes quickly" and click next
5. Wait patiently for the device to be added
6. Click on the gateway page to apply the gateway to add wireless devices

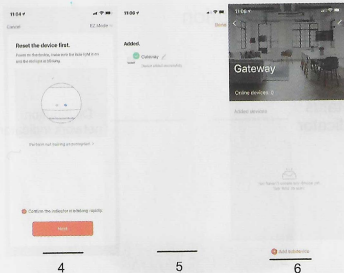

4

5

6

## Non-warranty regulations

- a. Unauthorized maintenance, misuse, collision, negligence, abuse, liquid ingress, accident, incorrect use of non-converter accessories; or tearing up or altering labels or anti-counterfeiting marks;
- b. The validity period of the three packs has expired;
- c. Damage caused by force majeure ;
- d. Circumstances that do not meet the performance failures listed in the "Product Performance Failure Table";
- e. Due to human reasons, the converter and its accessories produce performance failures listed in the "Product Performance Failure Table".

name	Performance failure
Zigbee wireless gateway	<ol style="list-style-type: none"> <li>1. The product cannot be turned on after power on</li> <li>2. The status indicator is invalid</li> <li>3. Unable to configure the network</li> <li>4. Other hardware failures cause the function to be unavailable</li> </ol>

Note: The illustrations of products, accessories, user interface, etc. in the manual are all schematic diagrams and are for reference only. Due to product updates and upgrades, the actual product shown on the product may be slightly different from the schematic diagram, please refer to the actual product